

GINATIC

Istruzioni per l'uso (IT)
Operating instructions (EN)

IST-MQC
04/2017

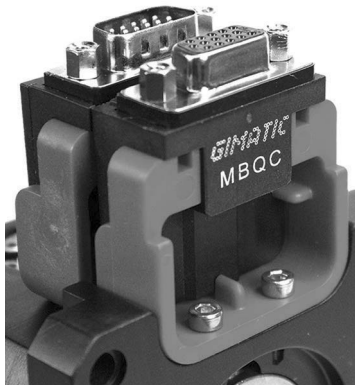

MAQC MBQC

Modulo di connessione elettrica
Electrical connection module

Modulo di connessione elettrica

- 15 connessioni elettriche.
- pin a tasteggio con teste autopulenti.
- attacco rapido I/O attraverso connettore VGA (opzionale).

Electrical connection module

- 15 electrical connections.
- feeler pin with self-cleaning heads.
- I/O quick connection using VGA connector (optional).

MAQC

MBQC

	MAQC	MBQC
Tipo di connessione I/O I/O connection type	15 pin D-SUB - Connettore alta densità ad angolo retto - Tipo VGA 15 pins D-SUB - High density elbow type - VGA type	
Corrente d'esercizio Working Current	3 A	
Gamma di tensione Voltage range	0 ÷ 300 V	
Temperatura di esercizio Temperature range	-55°C ÷ +105°C	
Contatti Contact	Dorati Gold plated	

Fissaggio

Fastening

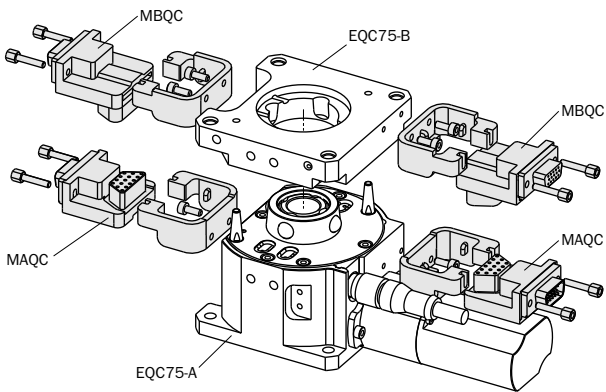

Dimensioni (mm)

Dimensions (mm)

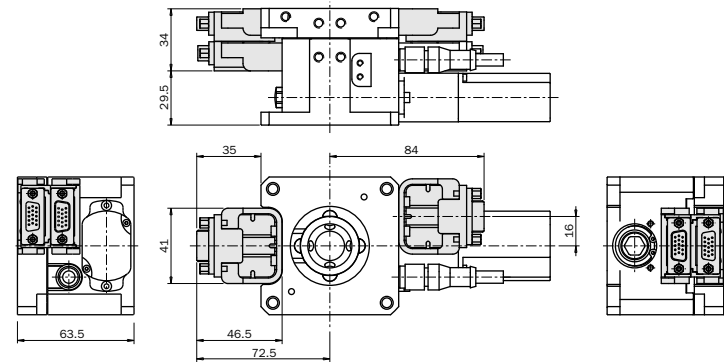

Cavo

A parte sono forniti i cavi maschio e femmina.

Cable

The male and female cables are supplied separately.



	CEQC-A	CEQC-B
Tipo di connessione I/O I/O connection type	15 pin D-SUB - Tipo VGA 15 pins D-SUB - VGA type	
Lunghezza cavo Cable length	1500 mm	
Isolamento Insulation	PVC codifica colori standard PVC premium grade color coded	
Schermatura Shield	100% alluminio - Pellicola di mylar - 28+26 AWG 100% aluminium - Mylar foil - 28+26 AWG	
Guaina Jacket	PVC nero Black PVC	
Temperatura di esercizio Temperature range	-55°C ÷ +105°C	
Gamma di tensione Voltage rating	0 ÷ 300 V	

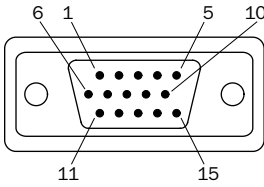
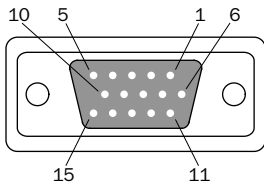
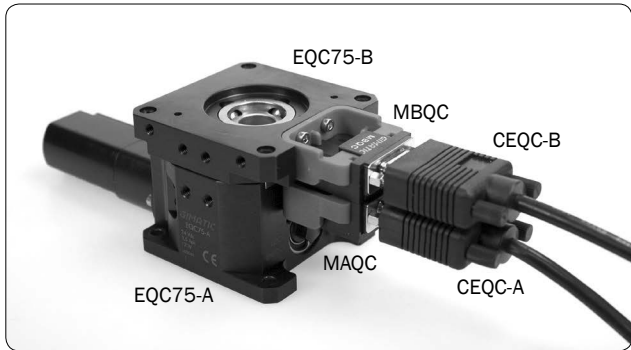

CEQC-AC, CEQC-BC (opzionali)

Sono forniti separatamente i connettori a saldare maschio e femmina.

CEQC-AC, CEQC-BC (optional)

The male and female solder connectors are supplied separately.

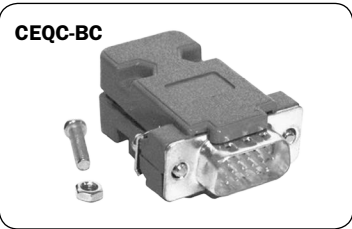
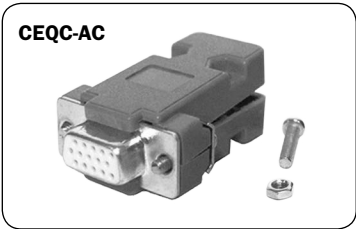

	CEQC-AC	CEQC-BC
Tipo di connessione I/O I/O connection type	15 pin D-SUB - Tipo VGA 15-pin D-SUB - VGA type	
Contatti Contacts	Rame Copper	
Isolamento Insulation	Poliestere Polyester	
Temperatura di esercizio Temperature range	-20°C ÷ +80°C	
Gamma di tensione Voltage range	0 ÷ 300 V	
Corrente massima Max current	3A	

GINATIC

Bedienungsanleitung (DE)
Notice d'utilisation (FR)

IST-MQC
04/2017

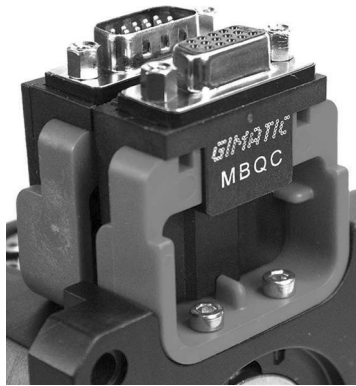

MAQC MBQC

Elektroverbindungsmodul
Module de connexion électrique

Elektroverbindungsmodul

- 15 elektrische Anschlüsse.
- Abtast-Pins mit selbstreinigenden Köpfen.
- Schnellanschluss I/O mit Hilfe von VGA-Verbinder (optional).

Module de connexion électrique

- 15 connexions électriques.
- broche palpeur avec tête auto-nettoyante.
- connexion rapide E/S avec connecteur VGA (en option).

MAQC

MBQC

	MAQC	MBQC
Anschlussstyp E/A Type de connexion I/O	15 D-SUB-Stifte - Winkelsteckverbinder - Typ VGA 15 goupilles D-SUB - Connecteur haute densité à coude - Type VGA	
Betriebsstrom Courant du travail	3 A	
Spannungsbereich Plage de tension	0 ÷ 300 V	
Betriebstemperatur Température d'utilisation	-55°C ÷ +105°C	
Kontaktstifte Connexions	Vergoldet Dorées	

Befestigung

Fixage

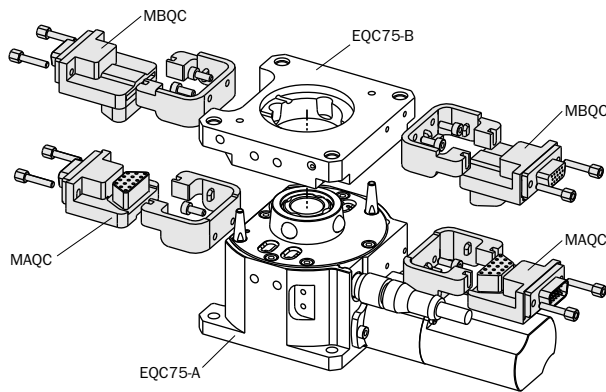

Maße (mm)

Abmessungen (mm)

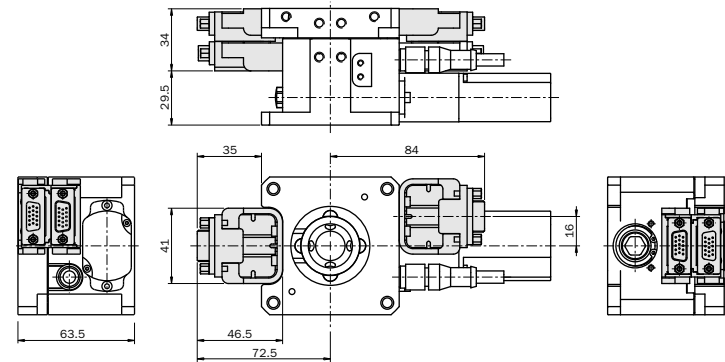

Kabel

The male and female cables are supplied separately.

Câble

Les câbles mâle et femelle sont vendus séparément.



	CEQC-A	CEQC-B
Anschlussstyp E/A Type de connexion I/O	15 D-SUB-Stifte - Typ VGA 15 pins D-SUB - Type VGA	
Kabellänge Longueur de câble	1500 mm	
Isolierung Isolation	PVC mit Standard-Farbcodierung PVC codification couleurs standard	
Abschirmung Blindage	100% Aluminium - Mylarfolie - 28+26 AWG 100% aluminium - film de mylar - 28+26 AWG	
Mantel Gaine	Schwarzes PVC PVC noir	
Betriebstemperatur Température d'utilisation	-55°C ÷ +105°C	
Spannungsbereich Gamme de tension	0 ÷ 300 V	

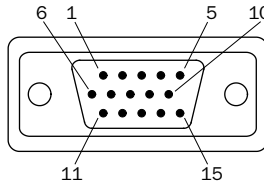
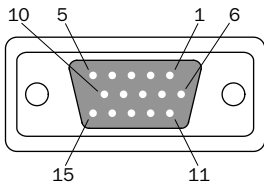
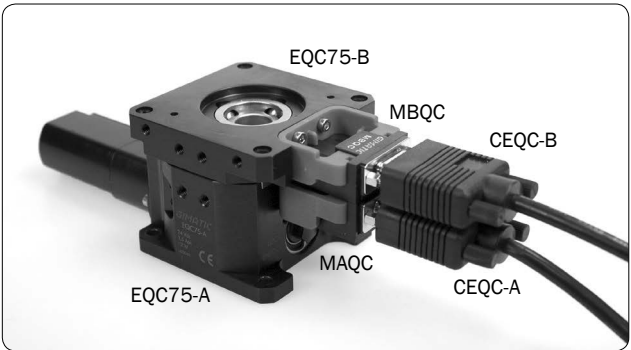

CEQC-AC, CEQC-BC (optional)

Die Vielfach-Schweißverbinder werden separat geliefert.

CEQC-AC, CEQC-BC (en option)

Les connecteurs mâle et femelle à souder sont vendus séparément.

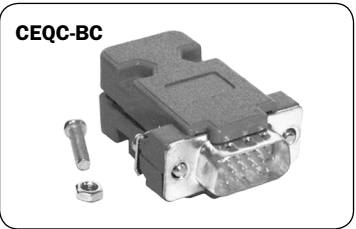
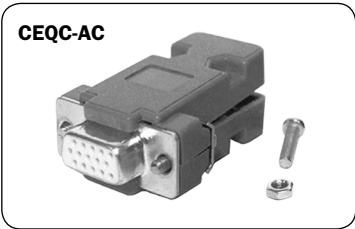

	CEQC-AC	CEQC-BC
Anschlussstyp I/O Type de connexion E/S	15-poliger D-SUB Typ VGA D-SUB 15 broches - type VGA	
Kontakte Contacts	Kupfer Cuivre	
Isolierung Insulation	Polyester Polyester	
Betriebstemperatur Plage de température	-20°C ÷ +80°C	
Spannungsbereich Plage de tension	0 ÷ 300 V	
Maximaler Strom Courant maximum	3A	

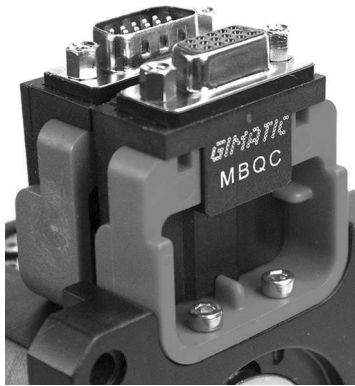

(中文) 操作说明
(JP) 動作の指示

IST-MQC
04/2017

MAQC MBQC

电气连接组件

電気配線用モジュール

电气连接组件

- 15 个电气连接
- 带有自清洁头的触针
- 使用 VGA 连接器（可选）的输入/输出快速连接

電気配線用モジュール

- 15の電気接続;
- 自浄式ヘッド付きのフィーラーピン;
- VGAコネクターを使用するI/Oスイッチ接続(オプション).



I/O连接类型 I/O接続タイプ	MAQC	MBQC
工作电流 動作電流	3 A	
额定压力 電圧定格	0 ÷ 300 V	
温度范围 温度範囲	-55°C ÷ +105°C	
接触 接触	鍍金 金メッキ	

紧固

固定

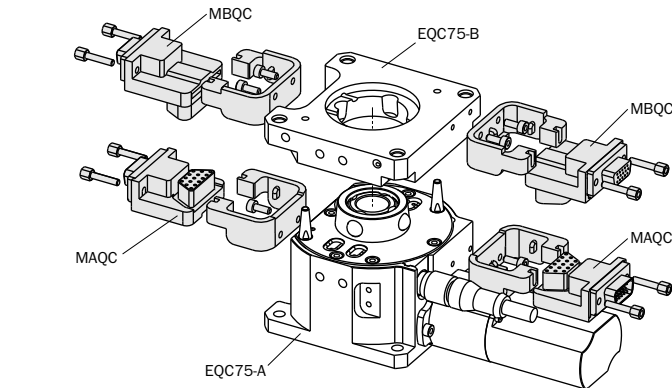

尺寸 (mm)

寸法 (mm)

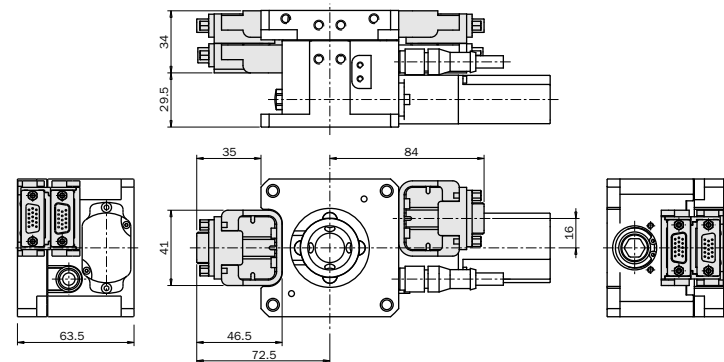

电缆

阴极, 阳极电缆分开提供。

ケーブル

メスおよびオスケーブルは別々に供給されます。



	CEQC-A	CEQC-B
I/O连接类型 I/O接続タイプ	15 针 D-SUB - VGA 类型 15ピン D-SUB - VGAタイプ	
电缆长度 ケーブル長さ	1500 mm	
绝缘体 絶縁	PVC 优质高档彩色编码 PVCプレミアムグレードのカラーコード	
屏蔽 シールド	100% 铝 - 聚酯薄膜 箔 - 28 ÷ 26 AWG 100%アルミニウム - マイラーホイル - 28 ÷ 26 AWG	
绝热罩 ジャケット	黑色 PVC 黒のPVC	
温度范围 温度範囲	-55°C ÷ +105°C	
额定压力 電圧定格	0 ÷ 300 V	

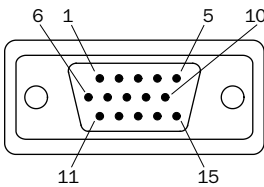
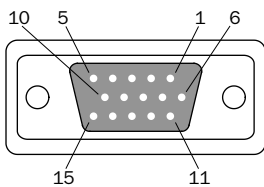
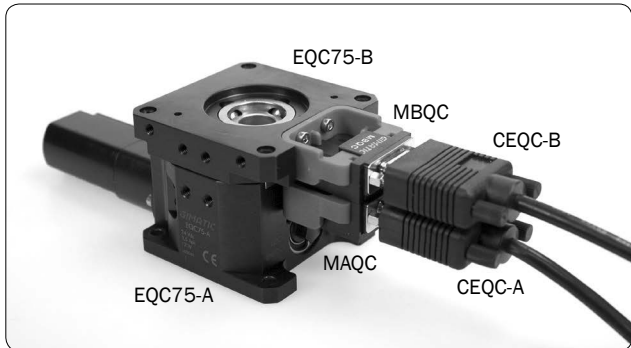

CEQC-AC、CEQC-BC

(可选)

单独提供阳性和阴性焊接连接器。

CEQC-AC、CEQC-BC

(オプション)

オスとメスのハンダコネクターは、別々に供給されます。

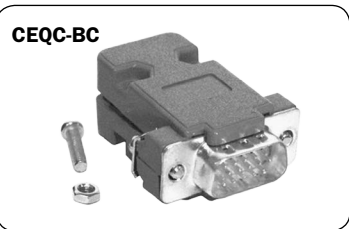
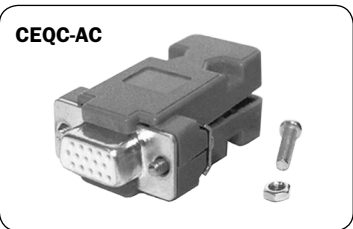

	CEQC-AC	CEQC-BC
输入/输出连接类型 I/O接続タイプ	15 针 D-SUB - VGA 型 15ピンD-SUB - VGAタイプ	
接触器 接点	铜 銅	
绝缘体 絶縁	聚酯 ポリエステル	
温度范围 温度範囲	-20°C ÷ +80°C	
电压范围 電圧範囲	0 ÷ 300 V	
最高电流 最大電流	3A	

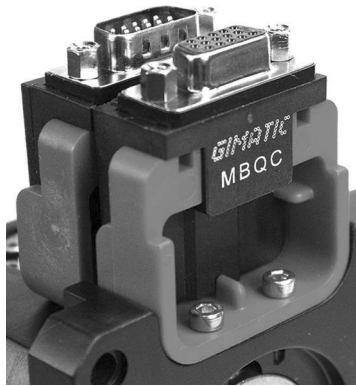

작동 지침(한국어)
(TR) Çalışma talimatları

IST-MQC
04/2017

MAQC MBQC

전기 배선 모듈

Elektriksel bağlantı modülü

전기 배선 모듈

- 15 전기 연결;
- 자동 세척 헤드가 있는 필러 핀;
- I/O VGA 커넥터를 사용한 빠른 연결 (선택사항).

Elektriksel bağlantı modülü

- 15 elektrik bağlantısı;
- kendini temizleyen başlıklı algılayıcı pin;
- VGA konektörü ile I/O çabuk bağlantısı (opsiyonel).



	MAQC	MBQC
I/O 연결 유형 I/O bağlantı tipi	15 핀 D-SUB - 고밀도 엘보우 유형 - VGA 유형 15 pin D-SUB-yüksek yoğunluklu dirsek tipi - VGA tipi	
동작 전류 Çalışma akımı	3 A	
전압 정격 Voltaj aralığı	0 ÷ 300 V	
온도 범위 Çalışma Sıcaklığı	-55°C ÷ +105°C	
접촉 Temas yüzeyi	금도금 Altın kaplamalı	

잠금

Bağlantı

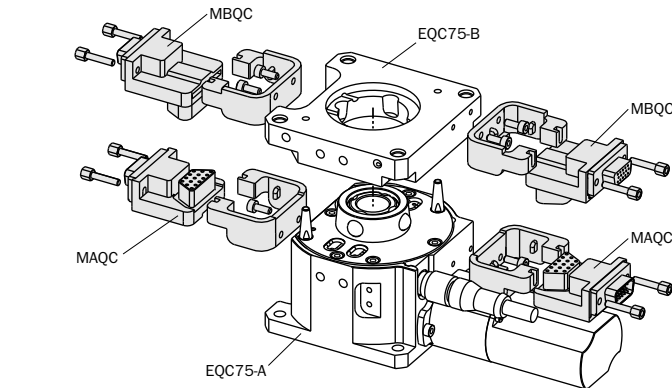

치수 (mm)

Ölçülendirme (mm)

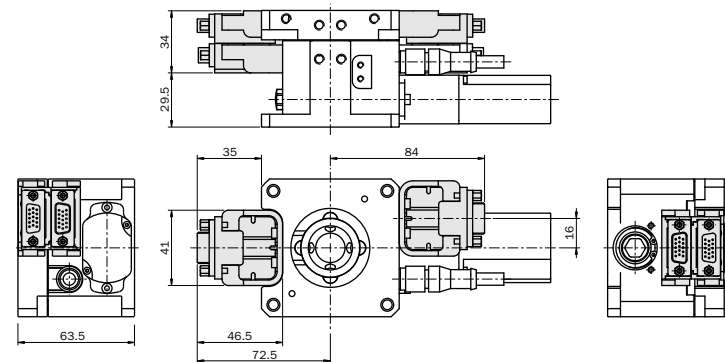

케이블

숫케이블과 암케이블은 별도로 제공됩니다.

Kablo

Erkek - dişi kablo (kod: CEQC) ayrı olarak tedarik edilir.



	CEQC-A	CEQC-B
I/O 연결 유형 I/O Bağlantı Tipi	15 핀 D-SUB - VGA 유형 15 pin D-Sub- VGA Tipi	
케이블 길이 Kablo uzunluğu	1500 mm	
절연 Yalıtım	PVC 프리미엄금 색상 코드 PVC Standart renk kodlu	
보호막 Kablo koruması	100% 알루미늄 - 마일라 금속 박막 - 28÷26 AWG %100 alüminyum - Mylar folyo - 28+26 AWG	
재킷 Kablo kılıfı	블랙 PVC Siyah PVC	
온도 범위 Çalışma Sıcaklığı	-55°C ÷ +105°C	
전압 정격 Voltaj aralığı	0 ÷ 300 V	

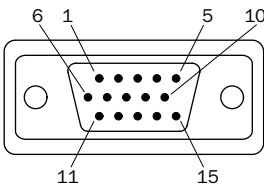
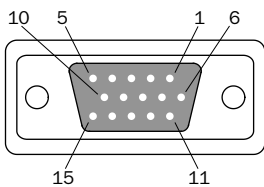
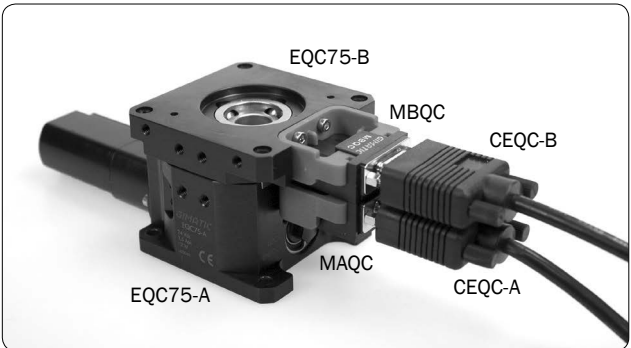

CEQC-AC、CEQC-BC

(선택사항)

암수 케이블 솔더 커넥터가 별도로 제공됩니다.

CEQC-AC、CEQC-BC (optional)

Erkek ve dişi lehimli konektörler ayrıca tedarik edilmektedir.

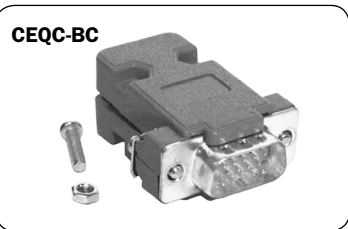
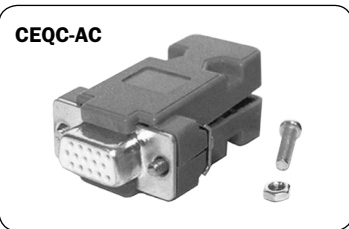

	CEQC-AC	CEQC-BC
I/O 연결 유형 I/O bağlantı tipi	15-pin D-SUB - VGA 유형 15-pin D-SUB - VGA tipi	
연락처 Kontaktlar	구리 Bakır	
절연 Yalıtım	폴리에스터 Poliester	
온도 범위 Sıcaklık aralığı	-20°C ÷ +80°C	
전압 범위 Voltaj aralığı	0 ÷ 300 V	
최대 전류 Azami akım	3A	